



RUSSELL SIMPSON

Bright and spacious three bed
houseboat to rent close to the King's
Road

CHEYNE PIER
CHELSEA SW10

Cheyne Pier

Let

BEDROOMS 3	INTERNAL 1,955 SQ FT 181 SQM	OUTDOOR 302 SQ FT	FURNISHED STATUS Furnished
BATHROOMS 3		EPC —	COUNCIL TAX —

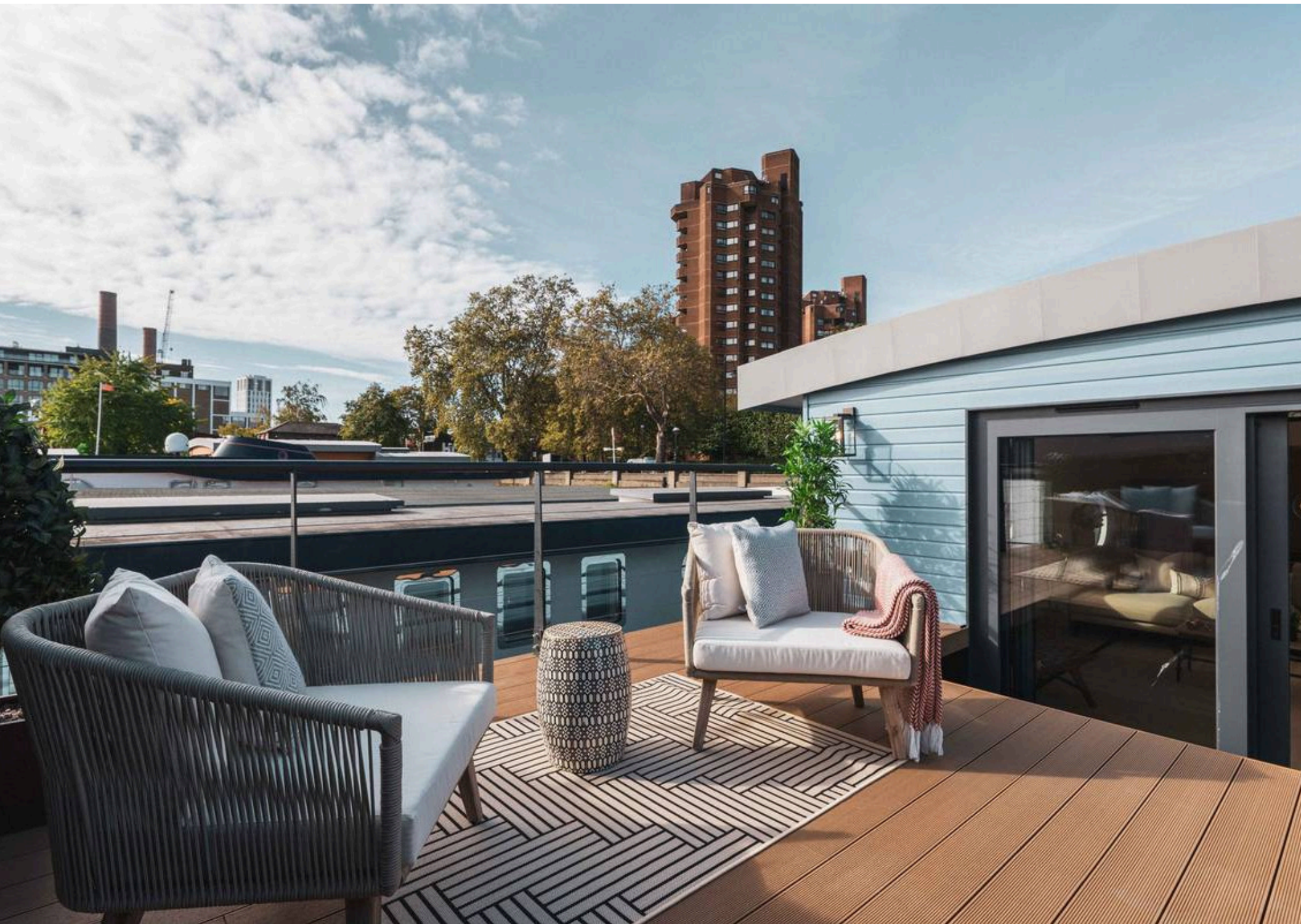

The Property

Three bedroom houseboat in Chelsea with a south-facing terrace and views over the Thames

The houseboat is decorated in a contemporary style, with light-filled interiors and a nautical theme. In addition, there is air conditioning throughout.





Indoor Spaces

Entering the houseboat on the upper deck, the front door leads into an open-plan kitchen with a separate dining area. A few stairs ascend to a reception room, with an overhead skylight and floor-to ceiling windows bringing in added brightness. In addition, sliding doors open onto a south-facing terrace.



The Bedrooms

There are three bedrooms on the lower deck. The principal bedroom has an ensuite bathroom, as well as a dressing room and additional storage space. The other two bedrooms share a second bathroom, there is a separate guest WC and a utility room on this floor.





Outdoor Spaces

The houseboat includes a south-facing terrace with wooden decking and enough space for outdoor eating. In addition, Cheyne Walk moorings offer a full on-site management team and night watchman.



The Neighbourhood

From Cheyne Walk moorings, the many restaurants and shops of the King's Road are all nearby. In addition, both Imperial Wharf and Fulham Broadway stations are close, while a riverbus service leaves from Cadogan Pier. Finally, the open spaces of Battersea Park are within walking distance on the opposite side of the Thames.

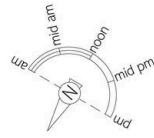

Cheyne Walk, Pacifica, Cheyne Pier, SW10

**RUSSELL
SIMPSON**

Approximate Internal Area
1,955 sq ft/ 182 sq m

Outside Area
302 sq ft/ 28 sq m

This plan is for layout guidance only. Not drawn to scale unless stated. Windows and door openings are approximate. Whilst every care is taken in the preparation of this plan, please check all dimensions, shapes, and compass bearings before making any decisions reliant upon them.

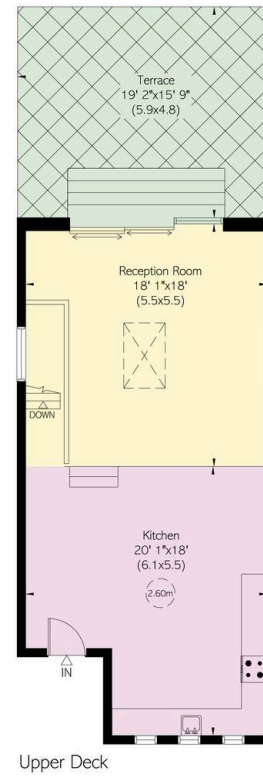

**RUSSELL
SIMPSON**

Contact Us

+44 (0) 20 7225 0277

151A Sydney Street
London
SW3 6NT

chelsea@russellsimpson.co.uk

In accordance with the Property Mis-Description Act 1991, the following details have been prepared in good faith, and are not intended to constitute part of an offer or contract. Any information contained herein (whether in the text, plans or photographs) is given in good faith but should not be relied upon as being a statement of representation of fact. Nothing in these Particulars shall be deemed to be a statement that the property is in good condition or otherwise nor that any services or facilities are in good working order. Any measurements of distances referred to herein are approximate only. October 2021