

RUSSELL SIMPSON

A well balanced one bedroom flat
with a stunning South-facing garden

BARTLE ROAD
NOTTING HILL W11

Bartle Road

Sold

| | | | |
|-----------------------------|---------------------------|------------------------|----------------------------|
| BEDROOMS 1 | INTERNAL 374 SQ FT | OUTDOOR — | COUNCIL NHL |
| BATHROOMS 1 | 34 SQM | EPC C | COUNCIL TAX C |
| TENURE Share of freehold | LEASE LENGTH 953 YEARS | GROUND RENT £10 P/Y | SERVICE CHARGE £946 P/Y |



The Property

The property benefits from its own front door, the option for off-street parking alongside the eligibility to apply for a residents permit.





The Neighbourhood

Bartle Road is quiet street conveniently located in the Kensington and Chelsea borough, moments from Ladbrooke Grove, Portobello Road and Westbourne Grove giving access to all the eclectic shops, restaurants and bars on offer in the area.

Bartle Road, W11

APPROX. GROSS INTERNAL AREA *
374 Sq Ft - 34.74 Sq M

This floorplan is for GUIDANCE ONLY and NOT FOR VALUATION purposes.

Key :
CH - Ceiling Height

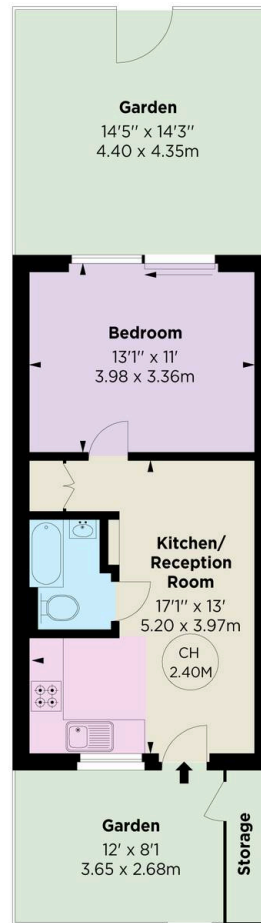

© Alex Winship Photography Ltd.

GROUND FLOOR



© RUSSELL SIMPSON
ADDRESS: 40-42, 27, 722-1011
EMAIL: info@russellsimpson.co.uk
RUSSELL SIMPSON

**RUSSELL
SIMPSON**

Contact Us

+44 (0) 20 7225 0277

Contact us

info@russellsimpson.co.uk

Sydney Street

+44 (0) 20 7225 0277

151A Sydney Street

London

SW3 6NT

chelsea@russellsimpson.co.uk

Kensington Square

+44 (0) 20 3761 9691

13 Kensington Square

London

W8 5HD

kensington@russellsimpson.co.uk